

## Technical Specifications

<b>Power supply</b>	2x 1.5V AA batteries
<b>Power consumption</b>	when Wake Up off (one activation per month): standby: 3.9µW typ: 5.3µW max: 92mW when Wake Up on (default settings, one hour active per day): standby: 118µW typ: 145µW max: 92mW
<b>Power loss</b>	max. 92mW
<b>Battery lifetime</b>	up to 5 years
<b>Interfaces</b>	Loxone Air: 868MHz (SRD Band Europe), 4 channels available max. Power 15.1mW e.r.p. 915MHz (ISM Band Region 2), 10 channels available max. Power 13.2mW
<b>Ambient temperature</b>	-18 ... 55°C / 0 ... 131°F
<b>Humidity</b>	max. 95% r. H. (non condensing)
<b>Touch points</b>	1 Touch point, tactile switch
<b>Feedback</b>	visual
<b>Safety rating</b>	IP64
<b>Dimensions</b>	84x84x30.5mm / 3.31x3.31x1.2" (LxWxH)
<b>Maintenance &amp; Cleaning</b>	This device is free of maintenance and may only be cleaned with a dry cloth.

# LOXONE

# LOXONE

## Need Help?

[loxone.com/support](https://loxone.com/support)



## Button Air

**Loxone Electronics GmbH**  
Smart Home 1  
4154 Kollerschlag  
Austria

[loxone.com](https://loxone.com)



V250521

Part No: 100465

## About the product

The Button Air is a highly visible, battery-powered device for triggering a button press. The magnetic wall bracket and non-slip base allow for use in a variety of settings. The magnetic wall mount and anti-slip base provide great flexibility and ability to position the Button Air wherever it is most convenient. An action triggered by the Button Air is indicated by a flashing red LED.

## Features

- Large single push button
- Visual feedback
- Magnetic wall mount
- Anti-slip base

## Installation

The Button Air is powered by two AA batteries, and is activated by removing the pull tab. Once the Button Air is activated, simply configure it in Loxone Config in the usual way.

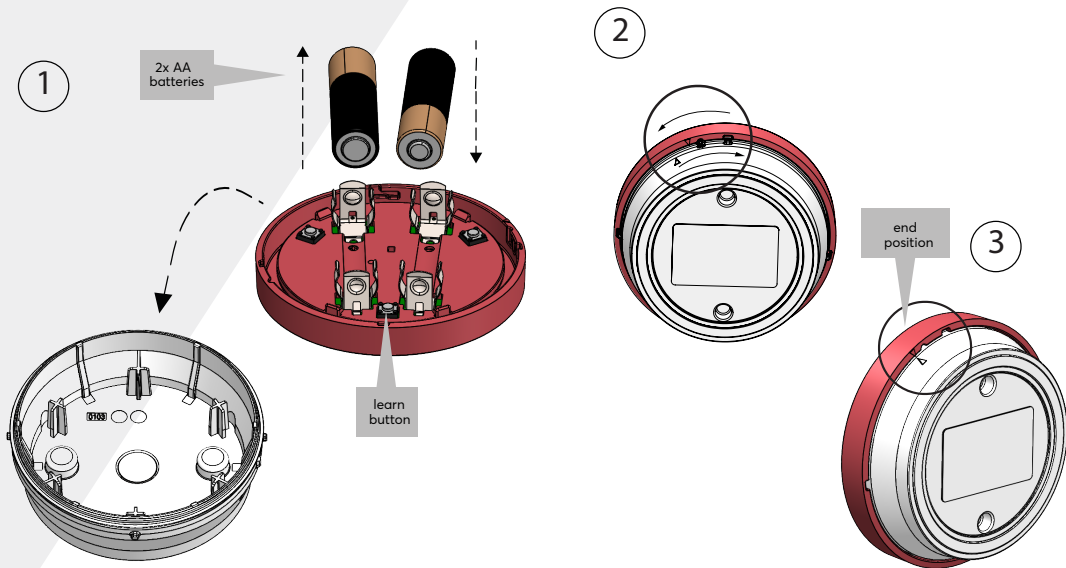
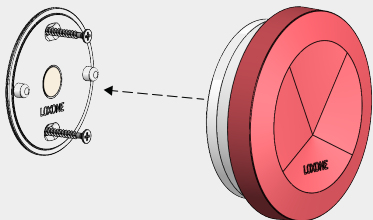

For additional information, declaration of conformity, visit [www.loxone.com/help/button-air](http://www.loxone.com/help/button-air)

## Information

Contains FCC ID: 2ARRV-000376

This device complies with part 15 of the FCC Rules.

Operation is subject to the following two conditions:

1. This device may not cause harmful interference
2. This device must accept any interference received, including interference that may cause undesired operation