

Inbetriebnahme und Montageanleitung

Touch Pure Air

Art. Nr.: 100399, 100400

Versorgung mit 24V

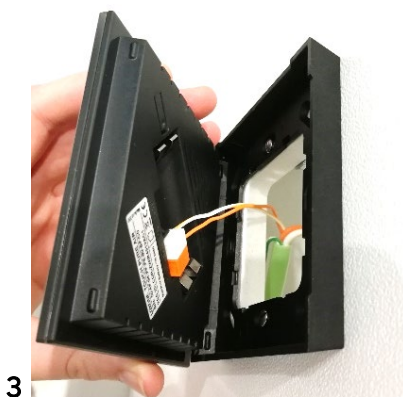
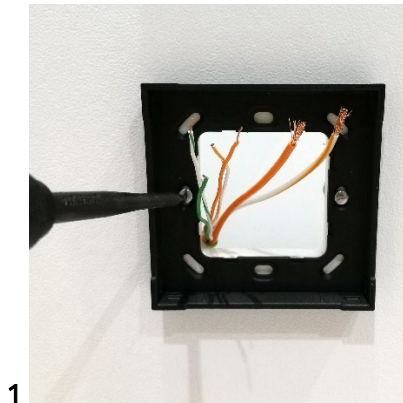

Versorgung mit Batterien

Wandmontage

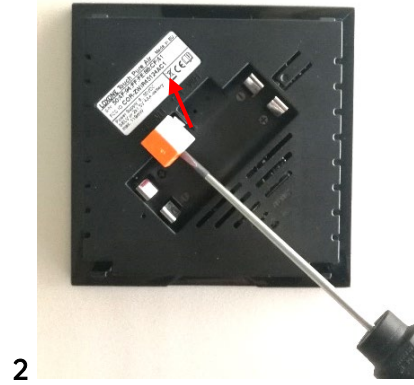
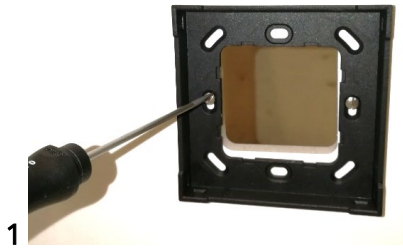

Versorgung mit Batterien

Optional: flexible Montage

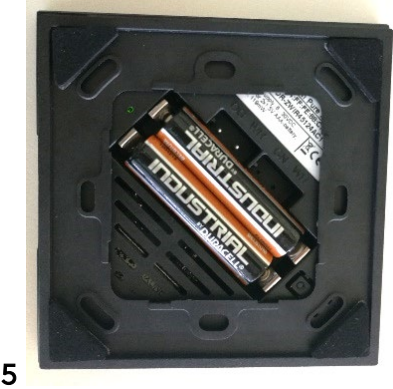
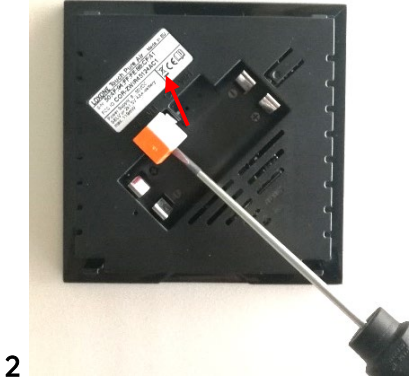

Touch Pure Air in Loxone Smart Home integrieren:

01 | Loxone Air Gerät einlernen:

loxone.com/help/airdevice

02 | Loxone Config:

Mit F5 den gewünschten Baustein anlegen. Aus dem Peripheriebaum "Touch Pure Air" die jeweiligen Elemente in die Loxone Config ziehen.

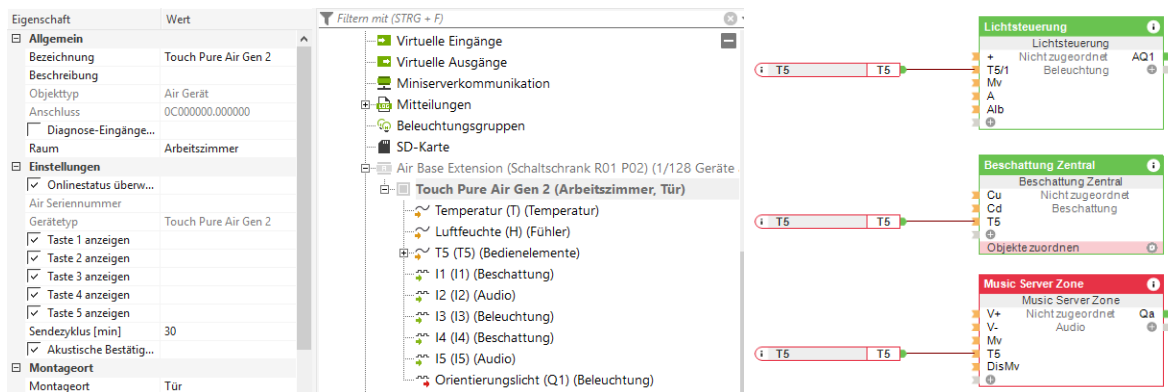

03 | Funktionsbeschreibung

loxone.com/help/touch-pure-air

Veröffentlicht von

Loxone Electronics GmbH
Smart Home 1
4154 Kollerschlag
Austria
Tel: +43 7287 7070-0
loxone.com

Pairing and installation instructions

Touch Pure Air

Part No: 100399, 100400

Supply with 24V

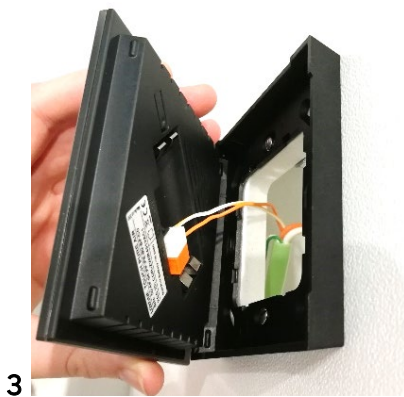
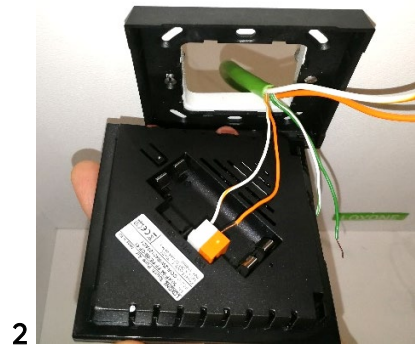
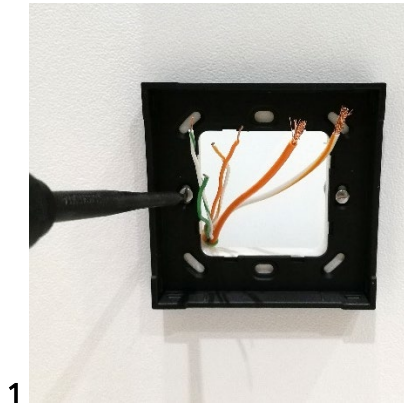

Battery Supply

Wall Mounting

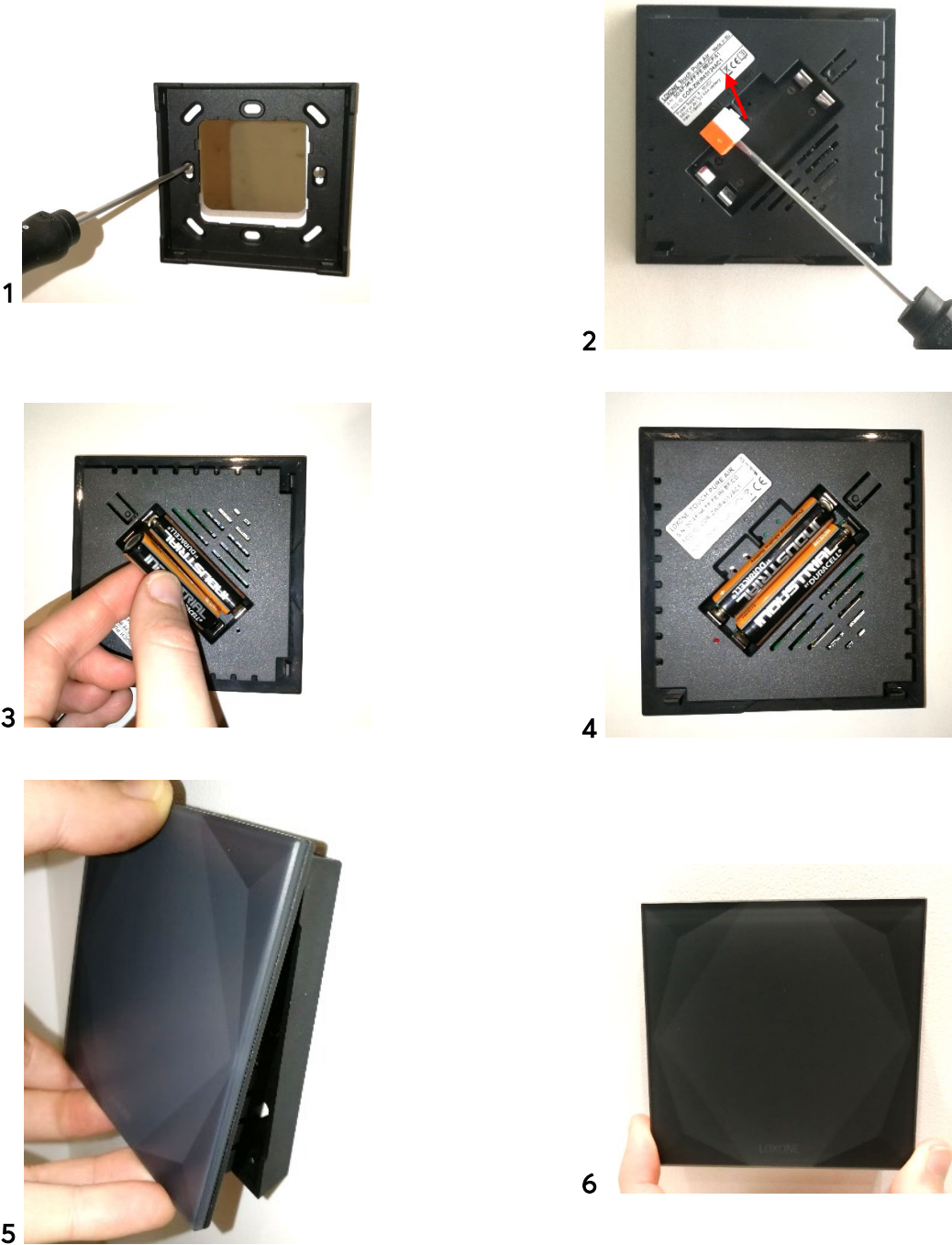

Battery Supply

Optional: Freestanding

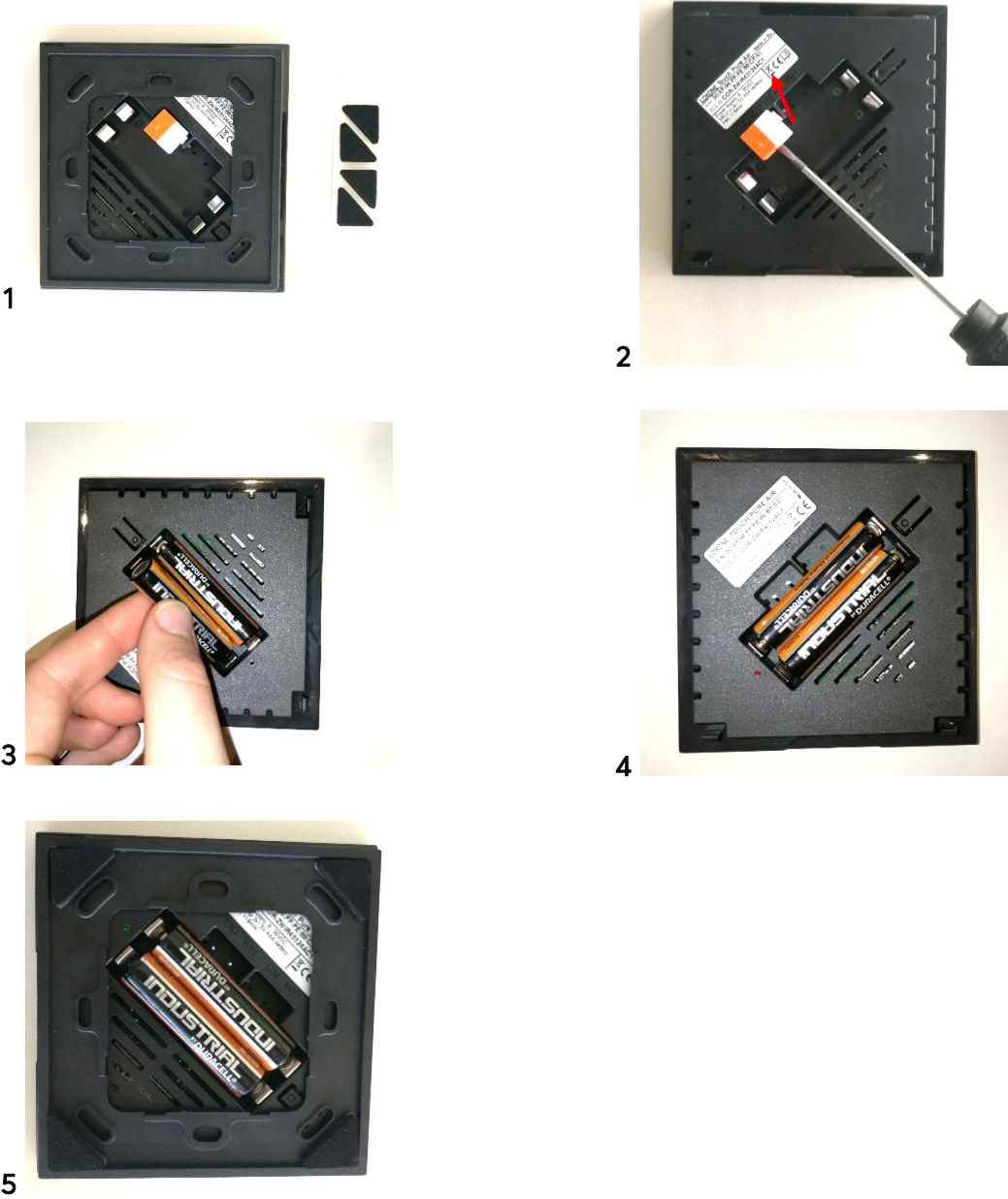

Integrate the Touch Pure Air into your Loxone Smart Home:

01 | Pair Loxone Air device:

loxone.com/help/airdevice

02 | Loxone Config:

Add the relevant module with F5. Nested beneath the Touch Pure Air, click and drag the respective item from the periphery tree across to the relevant page within Loxone Config

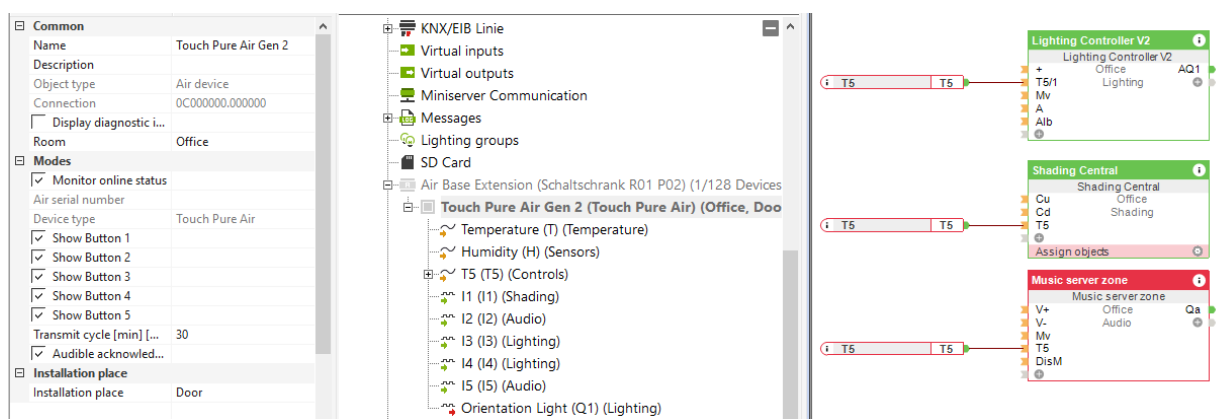

03 | Description of function

loxone.com/help/touch-pure-air

Published by

Loxone Electronics GmbH
Smart Home 1
4154 Kollerschlag
Austria
Tel: +43 7287 7070-0
loxone.com