

Inbetriebnahme und Montageanleitung

Nano 2 Relay Tree

Art. Nr.: 100395

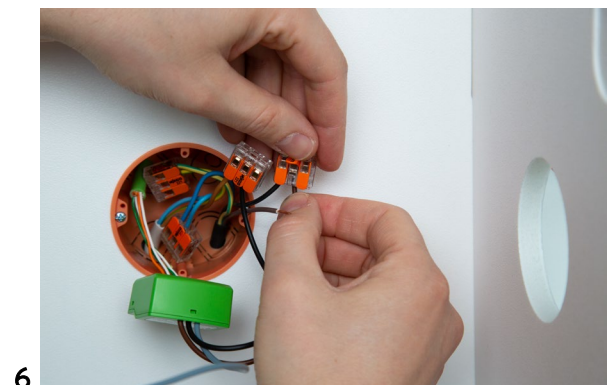

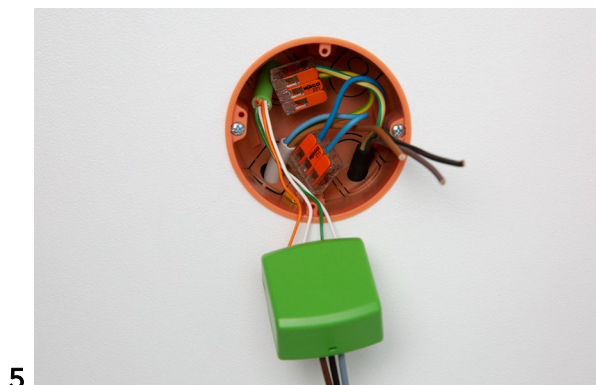
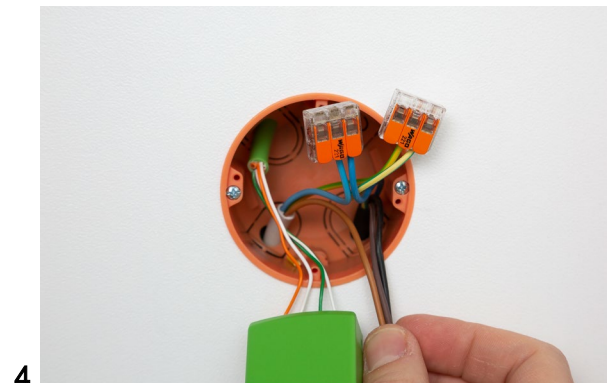
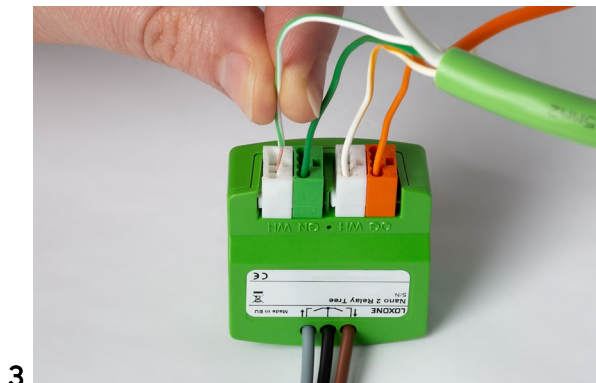
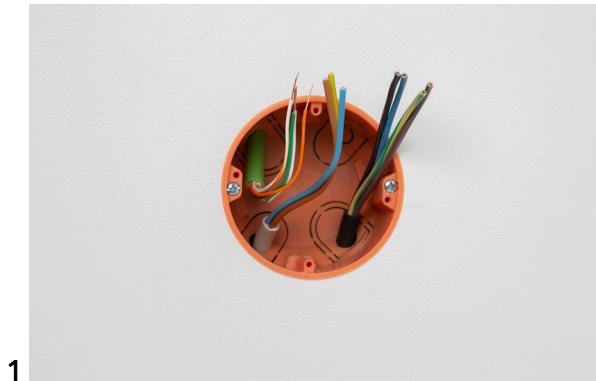
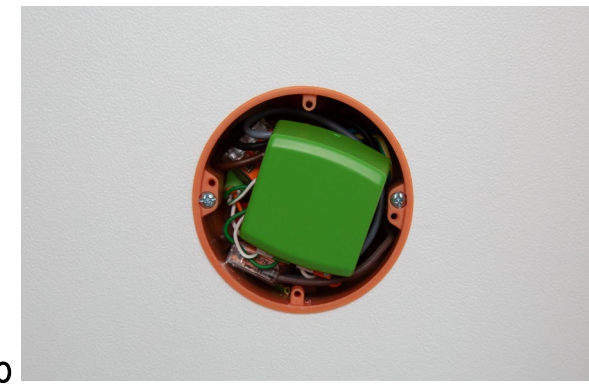
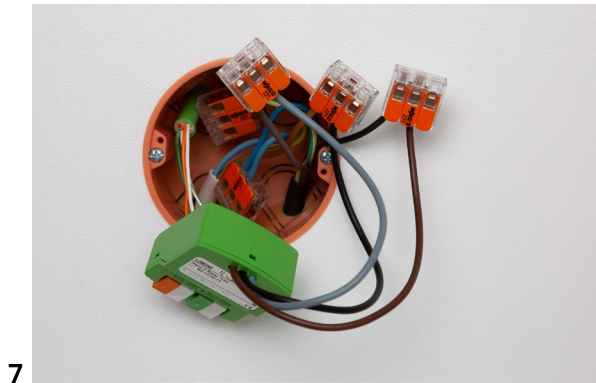

Nano 2 Relay Tree in Loxone Smart Home integrieren:

01 | Loxone Tree Gerät einlernen:

loxone.com/help/treedevice

02 | Loxone Config:

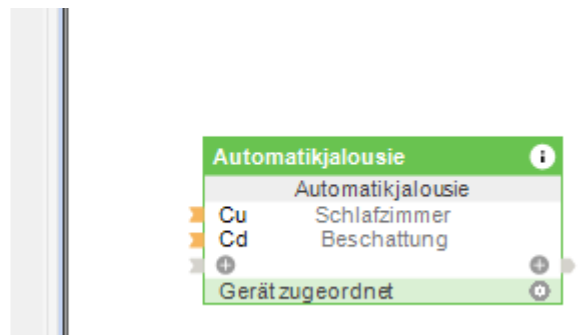
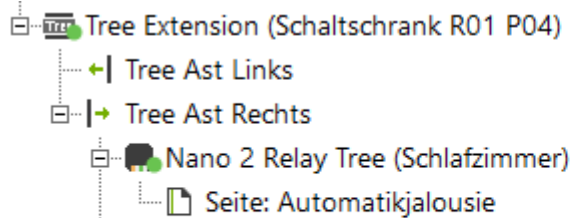

Aus dem Peripheriebaum, den Baustein "Nano 2 Relay Tree" in die Loxone Config ziehen.

Variante 1: Automatikjalousie



Variante 2: 2 frei programmierbare digitale Relaisausgänge

 **Nano 2 Relay Tree (Schlafzimmer)**

-  Stromfluss (I) (Überwachung)
-  Auf (Q1) (Beschattung)
-  Ab (Q2) (Beschattung)

03 | Baustein Nano 2 Relay Tree konfigurieren:

loxone.com/help/nano-2-relay-tree

04 | Funktionsbeschreibung

loxone.com/help/nano-2-relay-tree

Veröffentlicht von

Loxone Electronics GmbH

Smart Home 1

4154 Kollerschlag

Austria

Tel: +43 7287 7070-0

loxone.com

Pairing and installation instructions

Nano 2 Relay Tree

Part No.: 100395

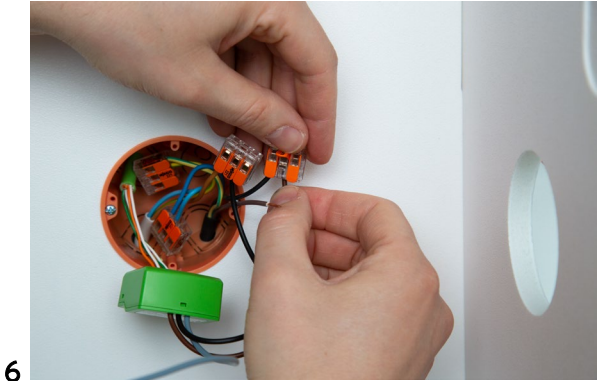
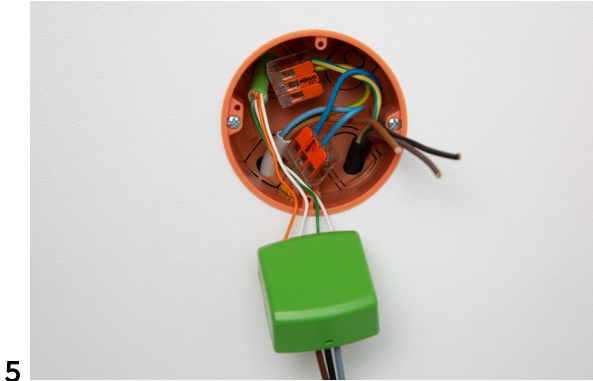
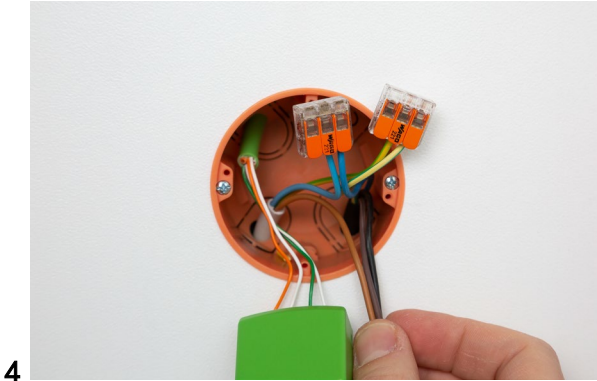
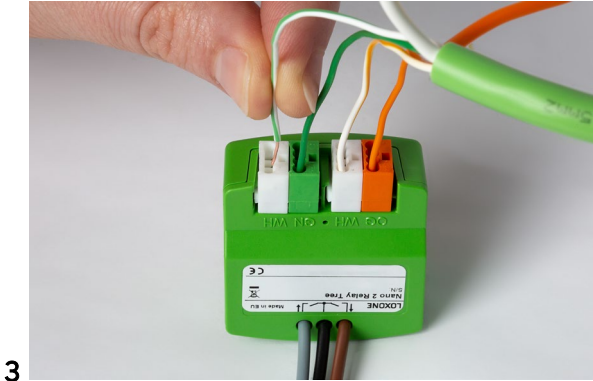
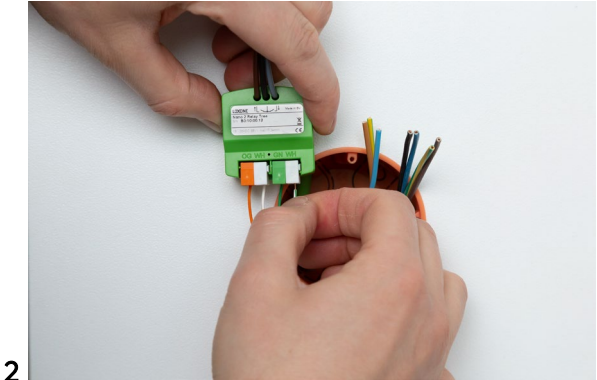
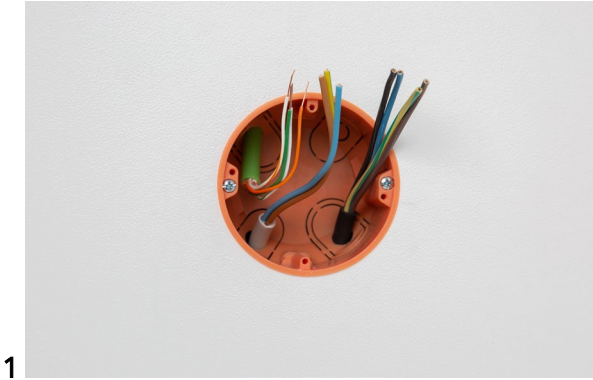

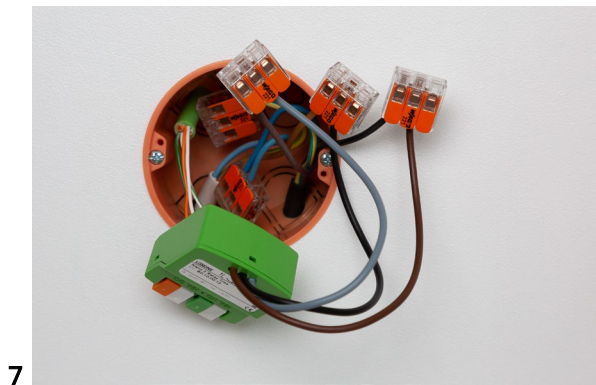

7



8

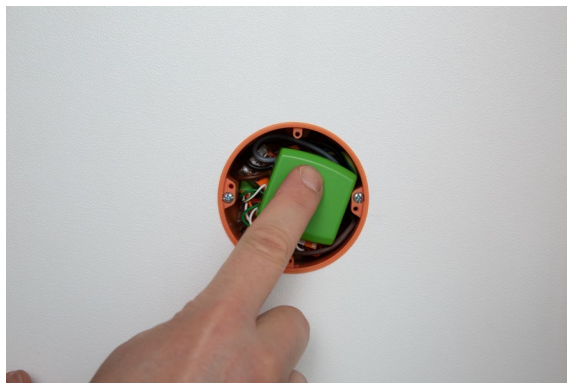

9

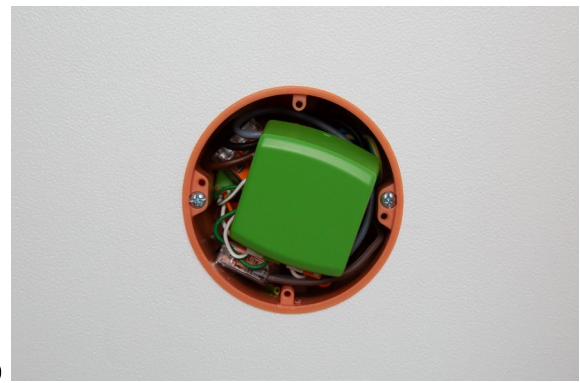

10

Integrate Nano 2 Relay Tree in your Loxone Smart Home:

01 | Learn-in Loxone Tree device:

loxone.com/help/treedevice

02 | Loxone Config:

Pull the "Nano 2 Relay Tree" module from the peripheral tree into the Loxone Config:

Variant 1: Automatic Blinds

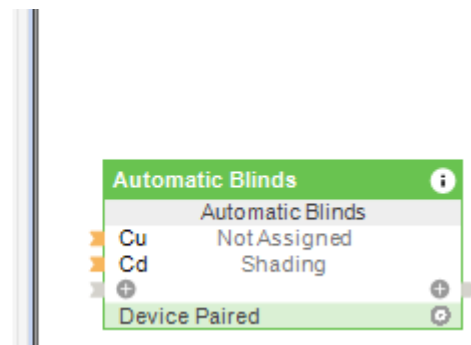
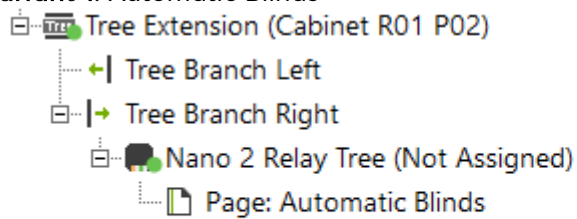

Variante 2: 2 freely programmable digital relay outputs

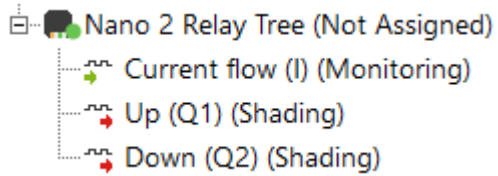

03 | Configure Nano 2 Relay Tree module:

loxone.com/help/nano-2-relay-tree

04 | Description of function

loxone.com/help/nano-2-relay-tree

Published by

Loxone Electronics GmbH

Smart Home 1

4154 Kollerschlag

Austria

Tel: +43 7287 7070-0

loxone.com